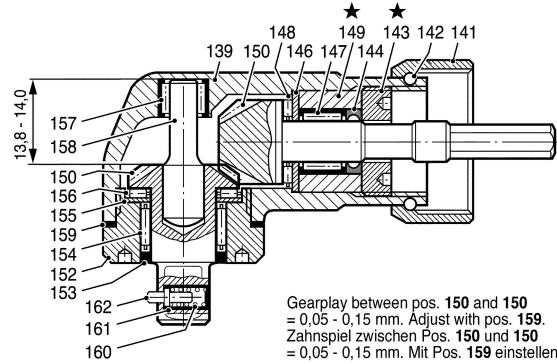
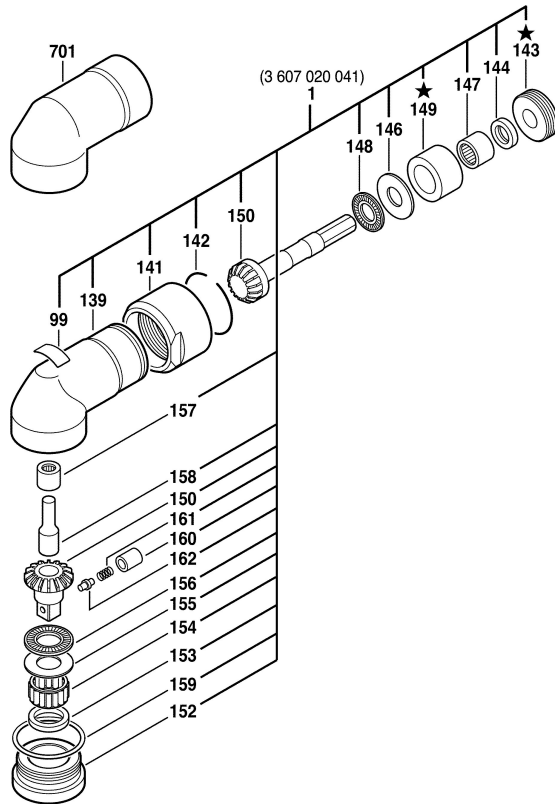

**Fig./Abb. 1**



Gearplay between pos. 150 and 159  
 = 0,05 - 0,15 mm. Adjust with pos. 159.  
 Zahnspiel zwischen Pos. 150 und 159  
 = 0,05 - 0,15 mm. Mit Pos. 159 einstellen.

Anzugsmomente  
 Torque values  
 Couple de serrage  
 Pares de apriete  
 Pos. 143 = 30,0 - 34,0 Nm  
 152 = 30,0 - 34,0 Nm

★ mit Loctite 222 sichern  
 secure with Loctite 222

Dimensions in mm/ Maße in mm  
 Cotes en mm/ Medidas en mm

Modifications reserved  
 Änderungen vorbehalten  
 Modifications réservées  
 Salvo modificaciones